

**Massachusetts Department of Environmental Protection
Bureau of Resource Protection - Wetlands**

Foxborough

WPA Form 1- Request for Determination of Applicability

Massachusetts Wetlands Protection Act M.G.L. c. 131, §40
Foxborough Wetlands Protection Bylaw, Chapter 267



A. General Information

Important:
When filling out forms on the computer, use only the tab key to move your cursor - do not use the return key.



1. Applicant or Property Owner's Representative:

Ryan & Tracy Slater

Name / Firm

Representative Name (if applicable)

16 Hill St

Mailing Address

Foxboro

City/Town

MA

State

02035

Zip Code

(508) 404-0686

Phone Number

slaterfamily2000@gmail.com

Email Address

gmail.com

2. Property Owner (if different from Applicant):

RECEIVED

MAY 30 2023

CONSERVATION COMMISSION

Name

E-Mail Address / Phone Number

Mailing Address

City/Town

State

Zip Code

3. Foxborough Wetlands Protection Bylaw filing fee enclosed:

Single Family House: \$75 Industrial / Other: \$200 Habitat Restoration / Scout Project: \$0

B. Determinations

1. I request that Foxborough Conservation Commission make the following determination(s).

- a. whether the **area** depicted on plan(s) and/or map(s) referenced below is an area subject to the jurisdiction of the State Wetlands Protection Act.
- b. whether the **work** depicted on plan(s) referenced below is subject to the Wetlands Protection Act.
- c. whether the **area and/or work** depicted on plan(s) referenced below is subject to the jurisdiction of the Foxborough Wetlands Protection Bylaw.

C. Project Description

1. a. **Project Location** (use maps and plans to identify the location of the area subject to this request):

16 Hill St

Street Address

Foxborough

Town

20

Assessors Map/Plat Number

424

Parcel/Lot Number

- b. **Area Description** (i.e. back yard, lawn, wooded area, conservation area, industrial, etc.):

Side yard adjacent to/attached to right side of house

- c. **Plan and/or Map Reference**

(Hint: hand-draw your proposed project onto an Assessor's map, Google map or MassGIS aerial photo.)

See attached assessor's map

Title

Date

Title

Date



Massachusetts Department of Environmental Protection

Bureau of Resource Protection - Wetlands

Foxborough

WPA Form 1- Request for Determination of Applicability

Massachusetts Wetlands Protection Act M.G.L. c. 131, §40

Foxborough Wetlands Protection Bylaw, Chapter 207



C. Project Description *(continued)*

2. a. **Detailed Description of Proposed Work**, shown in the above plans:

20x24 ft. addition extending existing right side of the house to add mudroom entranceway and family room with attic space above and basement under. (Separate from current basement).

- b. Identify provisions *(if any)* of the MA Wetlands Protection Act or regulations which may exempt the applicant from having to file a Notice of Intent for all or part of the described work.

3. a. **Riverfront Requirements** *(if applicable)*

If the proposed project is located within 200 feet of a river, indicate the one classification below that best describes the project:

For lots recorded on or before 8/1/96:

- Single family house on a lot recorded on or before 8/1/96
 Project, other than a single family house or public project, where the applicant owned the lot before 8/7/96

For lots recorded after 8/1/96:

- Single family house on a lot recorded after 8/1/96
 Expansion of an existing structure on a lot recorded after 8/1/96

Other Projects:

- Municipal project
 District, county, state, or federal government project
 Public project where funds were appropriated prior to 8/7/96
 Residential subdivision; institutional, industrial, or commercial project
 Project on a lot shown on an approved, definitive subdivision plan where there is a recorded deed restriction limiting total alteration of the Riverfront Area for the entire subdivision
 New agriculture or aquaculture project
 Project required to evaluate off-site alternatives in more than one municipality for an Environmental Impact Report under MEPA or in an alternatives analysis pursuant to an application for a 404 permit from the U.S. ACOE or 401 Water Quality Certification from the MassDEP.

- b. Provide evidence *(e.g., record of date subdivision lot was recorded)* supporting one of the classifications above *(use additional paper and/or attach appropriate documents, if necessary)*.

Evidence:

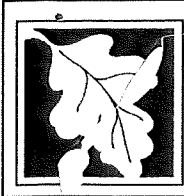

Massachusetts Department of Environmental Protection
Bureau of Resource Protection - Wetlands

Foxborough

WPA Form 1- Request for Determination of Applicability

Massachusetts Wetlands Protection Act M.G.L. c. 131, §40
Foxborough Wetlands Protection Bylaw, Chapter 267



D. Signatures and Submittal Requirements

Name and Address of Property Owner:

Ryan & Tracy Slater
Name

16 Hill St
Mailing Address

Foxboro
City/Town

MA
State

02035
Zip Code

I hereby certify under the penalties of perjury that the foregoing Request for Determination of Applicability and accompanying plans, documents, and supporting data are true and complete to the best of my knowledge.

I further certify that the property owner, if different from the applicant, and the appropriate MassDEP Regional Office (*see below*) were sent a complete copy of this Request (*including all appropriate documentation*) simultaneously with the submittal of this Request to the Conservation Commission.

Failure by the applicant to send copies in a timely manner may result in dismissal of the Request for Determination of Applicability.

I also understand that notification of this Request will be placed in a local newspaper (*by the Conservation Office*) at my expense in accordance with Section 10.05(3)(b)(1) of the Wetlands Protection Act regulations.

Signatures:

[Signature]
Signature of Applicant

5/22/23
Date

Signature of Representative (if any)

Date

Tax Collector's Release and Signature: The above referenced applicant is applying for a permit from the Conservation Commission and is in good standing with respect to any taxes, fees, assessments, betterments or other municipal charges as recorded with the Foxborough Treasurer's Office.

[Signature]
Signature of Foxborough Tax Collector or Agent

5/22/23
Date

Submittal Requirements:

For the Conservation Commission:

One (1) original and seven (7) copies of this completed Request (*including all plans, other documentation, and Town filing fee payment*), by mail or hand delivery to:

Foxborough Conservation Commission
40 South Street
Foxborough, MA 01035

For MassDEP:

One (1) copy of the completed Request (*including all documentation; no State filing fee is required*) by certified mail or hand delivery to:

MassDEP, Southeast Regional Office
20 Riverside Drive
Lakeville, MA 02347

SEPTIC SYSTEM

A	31.2	13
B		4
C		7
D		7

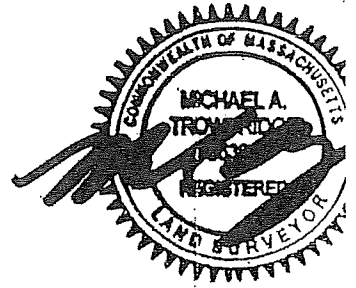
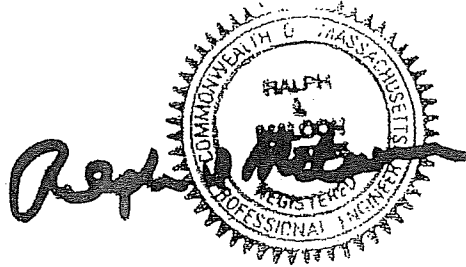

5.29'

80.19'

LOT 37
22,648 S.F.

23.42'

118.07'

39.66'

158.31'

WETLANDS

EDGE

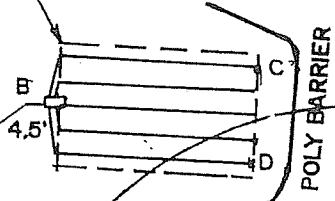
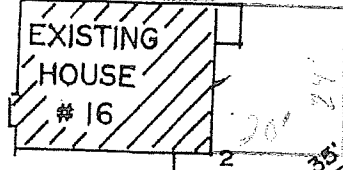

L = 123.26
R = 60.00

L = 27.40'
R = 30.00'

137.59'

ABANDONED CUL-DE-SAC

HILL STREET

ASSESSORS MAP 20

